

Mount Zion United Methodist Church
Masterplan Space Matrix

Space	Room #	Area (SF)	Notes
CLASSROOMS			
SMALL			
1	U-202	94	Sunday School Registration Area
2	EX-101	300	As-is
3	EX-103	279	As-is
4	EX-104	296	As-is
5	EX-105	105	Registration area
6	EX-201	207	As-is
7	EX-202	207	As-is
8	EX-203	339	As-is
9	EX-204	346	As-is
10	EX-205	346	As-is
11	EX-207	267	Reduced existing for corridor
MEDIUM			
1	U-209	425	Could join 210 w/moveable partition
2	U-210	467	Could join 209 w/moveable partition
3	U-211	409	Overlooks courtyard
4	EX-102	404	As-is
5	EX-107	458	Choir room
6	EX-206	476	As-is
7	G-102	703	Nursery w/registration area
STORAGE			
1	G-104	66	Pantry
2	G-114	55	Elevator Equipment
3	G-115	360	Gym Storage/Bleachers
4	G-117	226	Mechanical Room off Gym
5	G-119	122	Gym Storage
6	U-206	88	Classroom common storage
ENTRY LOBBY			
	G-101	751	Open to second level
GYMNASIUM/FELLOWSHIP			
	G-103	5894	Middle School size court
STAGE			
	G-105	879	North wall of Gym
LORD'S SHELTER			
	G-106	658	Outdoor undercover beside kitchen
KITCHEN			
	G-107	743	Includes pantry
HERITAGE CENTER			
	G-111	144	Includes library
PRAYER CHAPEL			
	G-112	496	Historic Chapel area
CAFE & GATHERING			
	G-113	1265	Gathering
RESTROOMS/SHOWERS			
	G-116	568	Includes family restroom
BREEZEWAY			
	G-118	511	Open air
SOUND BOOTH			
	U-201	202	Overlooks Gym
LOUNGE			
	U-203	324	Overlooks Gym
RESOURCE CENTER			
	U-204	353	SS Curriculum/Coop
ADDITIONAL RESTROOM			
	U-205	87	Overlooks Gym

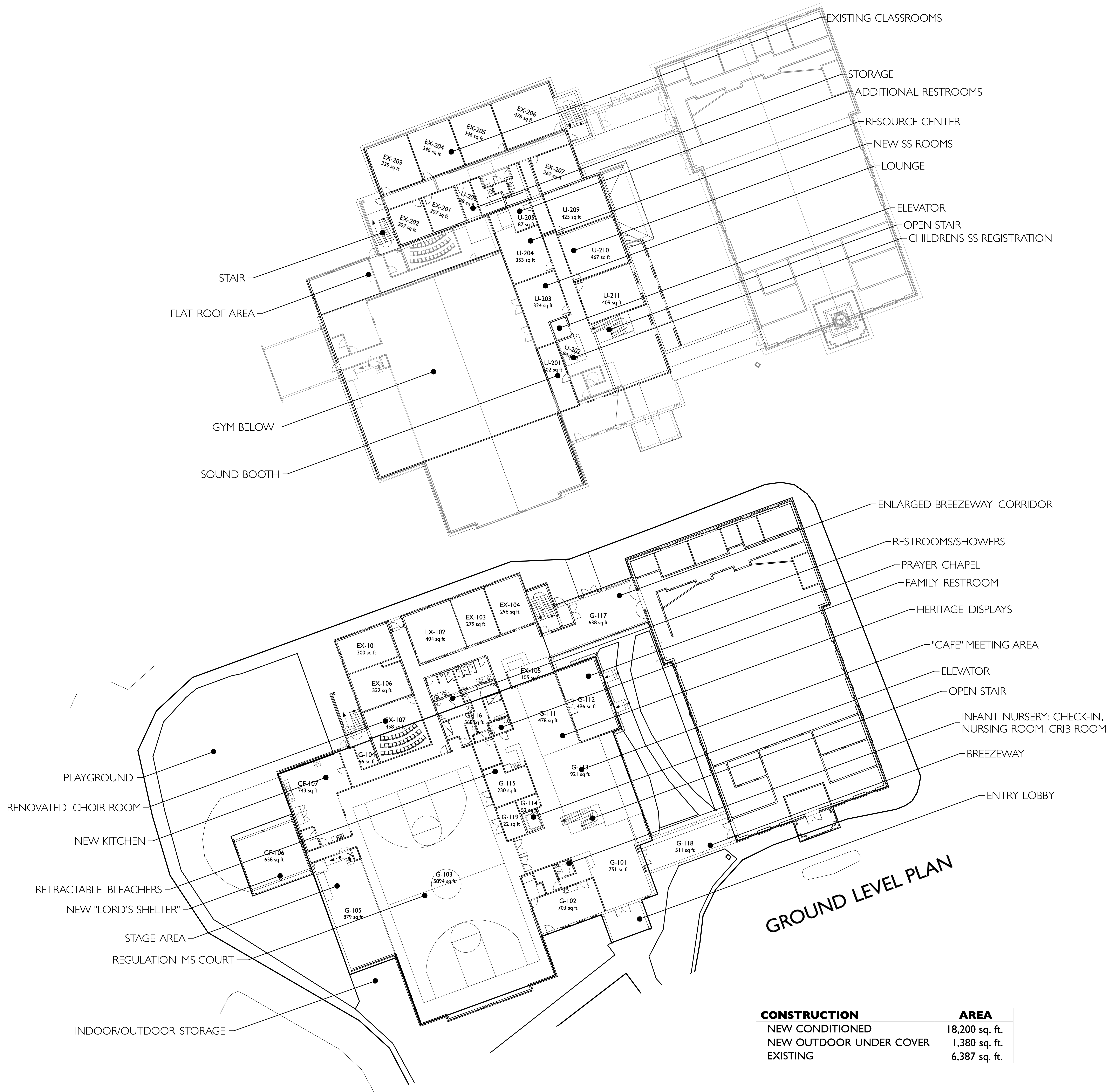

CONSTRUCTION	AREA
NEW CONDITIONED	18,200 sq. ft.
NEW OUTDOOR UNDER COVER	1,380 sq. ft.
EXISTING	6,387 sq. ft.

MOUNT ZION U.M. CHURCH MULTIPURPOSE BUILDING

SCALE AS NOTED
13732 NC 50 NORTH
GARNER, NC
10/4/15
mzc_bldg_4.01.rvt

gs architecture, p.a.
5710 University Drive, Suite 330
Durham, NC 27707
(919) 423-1331